

BRIT XII - 2012

Fukuoka / Busan

JAPAN KOREA

Conference Programme

Borderland Voices: Shaping a New World Order

Fukuoka Session

November 13 (tue) – 14 (wed), 2012

Fukuoka International Congress Center

Busan Session

November 16 (fri), 2012

Dongseo University



Table of Contents

Table of Contents	1
1. Words of Welcome	2
2. Supporters & Organizers.....	4
3. A Short History of BRIT	6
4. Venue & Transport – Fukuoka: 13 (Tue)-14 (Wed) November.....	7
5. Venue & Transport – Busan: 16 (Fri) November	11
6. Lunch & Banquet: Fukuoka Session.....	14
7. Sumo Wrestling Spectating: 14 (Wed) November.....	15
8. Musical “Tale of Tsushima”: 14 (Wed) November	16
9. Tsushima Field Trip: 15 (Thur) November.....	17
10. Conference Programme	19
11. General Information.....	34
12. Scientific Committee	36
13. Journal of Eurasia Border Review (EBR)	37

1. Words of Welcome

Welcome to BRIT XII-2012 Fukuoka (Japan) / Busan (Korea):

The XII International Scientific Meeting on Border Regions in Transition (BRIT) & The First BRIT in East Asia

Eurasia and East Asia has long been a “vacuum” in the international border studies community, with the current renaissance in border studies being fashioned mainly in the Americas and Europe. Hokkaido University’s Slavic Research Center, a world-renowned center for Eurasian studies, and the Global COE (Center of Excellence) Program “Reshaping Japan’s Border Studies,” aim to fill this “gap.” After months of preparation, and in collaboration with Kyushu University and Dongseo University, we have finally succeeded in organizing the twelfth Scientific Meeting on Border Regions in Transition (BRIT) that originated in Europe, and will succeed in holding the Conference in one of the most dynamic border regions in East Asia - namely the Fukuoka-Busan area.

The main conference and related satellite meetings are fully supported by the local administrations in Fukuoka, Tsushima and Busan, by the newly established border studies network - Japan International Border Studies Network (JIBSN), and by several related academic associations and projects such as the Japan Society of Island Studies and, internationally, the Association for Borderlands Studies (ABS). Thanks to the endeavors of all the concerned parties, the BRIT XII scientific meeting has gained momentum and attracted around two hundred participants from nearly forty countries. The Fukuoka-Busan venue will serve as a forum for researchers to learn about unknown borderland realities beyond their usual frame of reference. Japan and Korea, on the east edge of the Eurasian continent, represent an especially relevant place for discussing both land and sea border related issues.

Against the geopolitical background of a rapidly changing Eurasia, the theme of the meeting was set as “Borderland Voices: Shaping a New World Order.” Researchers address this theme by examining how people living in the borderlands have negotiated the process of being “bordered” by the state and central authority; the unique relations of these borderland communities with neighboring powers; and the strategies and initiatives that people on the borderlands have devised to overcome the challenges of daily life living on the border. Views from the borderlands give new insights into the dynamic relationship between state and society; center and periphery; security and insecurity; politics and territory; identity and belonging. The theme of BRIT XII comes as a timely reminder that it is border communities (often marginal, overlooked and powerless) who are most sharply affected by the global shifts represented by the terms “de-bordering” and “re-bordering.” For borderland communities the power, violence and connectivity of the border are part of the very fabric of daily life. The border really matters to those living on it and border studies can metaphorically and geographically give a voice to those people living on the margins. It is a scholarly engagement that has a humanitarian significance beyond the boundaries of academia.

In addition to presenting case studies on Eurasia and East Asia, BRIT XII offers opportunities to use multiple lenses (from local to global) as well as cross-disciplinary approaches to refocus on the border in a new and

BRIT XII-2012

13-16 November, 2012 Fukuoka (Japan) / Busan (Korea)

innovative manner. Border studies itself has yet to fully mature and needs a solid foundation to integrate fragmented regional facts. The urgent task at hand is to find and identify theoretical tools in order to compare various approaches and expertise across regions. Without this process, border studies, though endowed with rich and suggestive materials, will not be able to make a fruitful contribution as an interdisciplinary and multi-vectored field of research. The first and final plenary will debate on these conceptual innovations and provide the general context for BRIT XII.

With your cooperation and participation, the first East Asian BRIT is to be a historic event, making border studies a truly global discipline. We would like to express our sincere gratitude to all BRIT participants here in Fukuoka and Busan. Thank you for coming and we hope you enjoy the conference as well as take this great opportunity to experience the various local activities around the BRIT XII.

Sincerely,

Akihiro Iwashita

Coordinator of BRIT XII

Professor, Slavic Research Center, Hokkaido University, Japan

Project Leader of Global COE program "Reshaping Japan's Border Studies"

Vice President of Japan International Border Studies Network

2. Supporters & Organizers

Co-hosted by

Global COE Program "Reshaping Japan's Border Studies" & Slavic Research Center, Hokkaido University, Japan
Research Center for Korean Studies & Faculty of Law, Kyushu University, Japan
Center for Japan Studies, Dongseo University, Korea

Cosponsored by

Japan Society of Island Studies (JSIS)
Japan International Border Studies Network (JIBSN)
Kyushu Economic Research Center
Scientific Research on Innovative Areas "Comparative Research on Major Regional Powers in Eurasia"
Slavic Research Center, Hokkaido University

With the cooperation of

Fukuoka City Government
Fukuoka Convention & Visitors Bureau (FCVB)
Busan City Government
Busan Convention & Visitors Bureau (Busan CVB)

With the financial support from

The Murata Science Foundation
The Sasakawa Peace Foundation
Fukuoka Convention & Visitors Bureau (FCVB)

With the international support from

Association for Borderlands Studies (ABS)

Organizing Committee

Akihiro IWASHITA	Representative, Global COE program & Professor, Slavic Research Center, Hokkaido University, Japan
Jekuk CHANG	President, Dongseo University, Korea
Takatoshi MATSUBARA	Director, Research Center for Korean Studies, Kyushu University, Japan
Kaoru IZUMI	Professor, Faculty of Law, Kyushu University, Japan
Jeonghee KIM	Director, Center for International Exchange & Cooperation, Dongseo University, Korea
Takashi KIMURA	Research Fellow, Faculty of Law, Kyushu University, Japan
Hiroshi INOOKA	Research Fellow, Research Center for Korean Studies, Kyushu University, Japan
Takayoshi KABU	Deputy Manager, Kyushu Economic Research Center, Japan
Osamu MIYAHARA	Director, Trade Promotion Section, Fukuoka City Government, Japan
Chierh CHENG	Research Fellow, Slavic Research Center, Hokkaido University, Japan
Yasunori HANAMATSU	Research Fellow, Slavic Research Center, Hokkaido University, Japan

Staff

Ryoko ABE	Administrator, Slavic Research Center, Hokkaido University, Japan
Assel BITABAROVA	Ph.D. candidate, Slavic Research Center, Hokkaido University, Japan
Naomi CHI	Assistant Professor, Public Policy School, Hokkaido University, Japan
Tetsuro CHIDA	Research Fellow, Slavic Research Center, Hokkaido University, Japan
Shinkichi FUJIMORI	Assistant Professor, Slavic Research Center, Hokkaido University, Japan
Hiroshi FUKUDA	Assistant Professor, Center for Integrated Area Studies, Kyoto University, Japan
Yumiko GODA	Administrator, Slavic Research Center, Hokkaido University, Japan
Masanori GOTO	Assistant Professor, Slavic Research Center, Hokkaido University, Japan
Akihiro HIRAYAMA	Research Fellow, Slavic Research Center, Hokkaido University, Japan
Hiroshi ITANI	Research Fellow, Slavic Research Center, Hokkaido University, Japan
Katsumi KISHIDA	Administrator, Slavic Research Center, Hokkaido University, Japan
Katsuhiko KIYAMA	Assistant Professor, Slavic Research Center, Hokkaido University, Japan
Go KOSHINO	Assistant Professor, Slavic Research Center, Hokkaido University, Japan
Haruka MIYAZAKI	Research Fellow, Japan Society for the Promotion of Science, Japan
Taisho NAKAYAMA	Research Fellow, Japan Society for the Promotion of Science, Japan
Jinjoo PARK	Administrator, Center for International Exchange & Cooperation, Dongseo University, Korea
Paul RICHARDSON	Associate Professor, Far Eastern Federal University, Russia
Minori TAKAHASHI	Research Fellow, Japan Society for the Promotion of Science, Japan
Shoko USAMI	Technical Assistant, Slavic Research Center, Hokkaido University, Japan
Tatsumi YAMAGUCHI	Administrator, Center for Japan Studies, Dongseo University, Korea
Akane YAMAZAKI	Administrator, Slavic Research Center, Hokkaido University, Japan

Contact**Personnel**

Akihiro Iwashita
(Japan)

Jeonghee Kim
(Korea)

Address

Slavic Research Center
Hokkaido University

Center for International Exchange & Cooperation
Dongseo University

Kita 9, Nishi 7, Kita-ku, Sapporo
060-0809
JAPAN

San 69-1, Jurye 2-Dong, Sasang-Gu, Busan
617-716
KOREA

Phone: (+81) 11-706-2388
Fax: (+81) 11-706-4952

Phone: (+82) 51-320-2108
Fax: (+82) 51-320-2094

BRIT XII Website: <http://borderstudies.jp/brit2012/top.html>

BRIT XII Email: brit2012@borderstudies.jp

3. A Short History of BRIT

The location of the first BRIT meeting reflected the rapid and remarkable changes in borders in Eastern Europe in the early 1990s. This inaugural meeting was titled “Borders and Border Regions: New Roles in a Changing Global Context,” and was organized by:

- The Institute for Regional Studies of the Californias (IRSC) at San Diego State University
- The Institute of Regional Development and Structural Planning (IRS) in Erkner near Berlin
- The Science Center for Social Research (WZB) in Berlin
- The Institut des Etudes Politiques (IEP) in Paris

James Scott, Paul Ganster, Alan Sweedler (San Diego State University), Wolf-Dieter Eberwein, Didier Bigot, and others all helped with the organization of the meeting, with Wolf-Dieter and especially James doing much of the work on constructing the program and working out the local arrangements for the complex international meetings.

The spirit and complexities of this first meeting have been sustained until today while debates on border studies have been brought to new places. For the first time, BRIT has come to East Asia and the cooperation between Japan and Korea builds on BRIT's rich tradition of transcending borders. Previous BRIT meetings are:

- I. The German-Polish Border, June 1994
- II. The Russian-Finnish Border, July 1997
- III. The U.S.-Mexican Border, January 1999
- IV. The Indo-Pakistan Border, February 2000
- V. The Estonian-Russian Border, June 2001
- VI. Hungary and Borders with Croatia, Serbia, Romania, and Ukraine, September 2003
- VII. The Israeli-Palestinian Border, January 2005
- VIII. The Polish-Ukrainian Border, September 2006
- IX. The Canada-U.S. Border, January 2008
- X. The Chile-Peru Border, January 2009
- XI. The French-Swiss Border, September 2011

(Provided by Paul Ganster, BRIT I Coordinator)

4. Venue & Transport – Fukuoka: 13(Tue) – 14(Wed) November

Fukuoka International Congress Center (*Fukuoka Kokusai Kaigijo*)



Address

2-1, Sekijo-machi, Hakata-ku, Fukuoka City, Japan

Tel: 092-262-4111

From the Airport *NOTE: BRIT secretariat does NOT provide participants with any pickup service at the Airport.

(Metro+Bus)

Metro from the *Airport station* to *Hakata station* (5 min)

Bus No.88 from *Hakata Bus station E* to *Kokusai Kaigijo-Sun Palace Mae* (14min)

(Metro+Walk/Taxi)

Metro from the *Airport station* to *Nakasu-kawabata station* (7 min)

Walk from *Nakasu-kawabata station* (Exit No.6) (20 min) or Taxi from *Nakasu-kawabata station* (10 min & JPY 800)

(Taxi)

Taxi from the *Airport* to the *Fukuoka International Congress Center* (20 min & JPY 2,000)

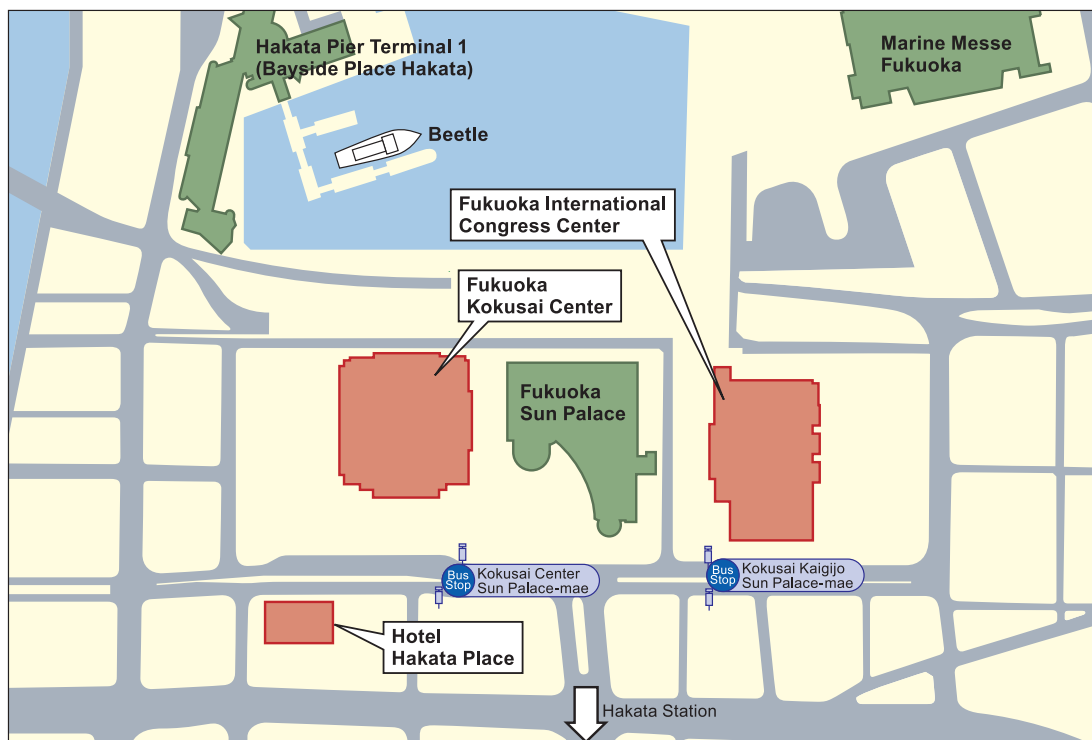



To Tenjin (Restaurant & Shopping district) from the conference venue

Bus No.80 from Kokusai Kaigijo-Sun Palace Mae to Tenjin Solaris Stage Mae (10 min)

Accommodation in Fukuoka

Hotel Hakata Place

Address: Chikkouhonmachi 3-16, Hakata-ku Fukuoka,
812-0021 Japan

TEL: (+81)- (0)92-404-7770

Check-in Time / 15:00; Check-out Time / 11:00

<https://conv.toptour.co.jp/2012/brit2012/BRIT-HOTEL-info02.pdf>

From the Airport

(Metro+Bus)

Metro from the *Airport station* to *Hakata station* (5 min)

Bus No.99 from *Hakata Bus station E* to *Kokusai Center-Sun Palace Mae* (13 min)

* You can check the location of the bus stop "Kokusai Center-Sun Palace Mae" in the map of p.7.

(Metro+Walk/Taxi)

Metro from the *Airport station* to *Nakasu-kawabata station* (7 min)

Walk from *Nakasu-kawabata station* (Exit No.6) (20 min) or Taxi from *Nakasu-kawabata station* (10 min & JPY 800)

(Taxi)

Taxi from the *Airport* to the *Fukuoka International Congress Center* (20 min & JPY 2,000)

To the Conference Venue (Walk): just 2 minutes walk west from the hotel

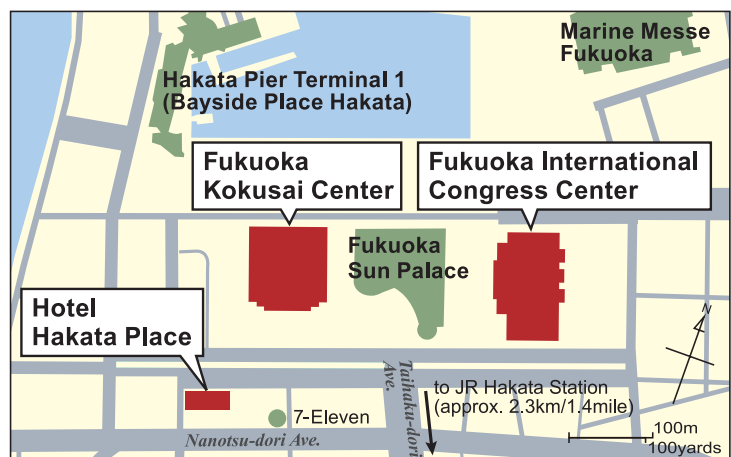

Hotel Eclair Hakata

Address: 1-1, Suzaki-machi, Hakata-ku,

Fukuoka 812-0028 Japan

TEL: (+81)-(0)92-283-2000

Check-in Time / 15:00; Check-out Time / 11:00

<http://yokanavi.com/eg/landmark/index/626>

From the Airport

(Metro+Walk)

Metro from the *Airport station* to

Nakasu-kawabata station (7 min)

Walk north from *Nakasu-kawabata station* (Exit

No.6) (2 min)

(Taxi)

Taxi from the *Airport* to the hotel (20 min + JPY

2,000)

To the Conference Venue

(Walk)

Walk west on *Showa-dori Ave.* and turn left onto *Taihaku-dori Ave.*, and walk north to a junction of three roads (20 min)

(Taxi)

Taxi from the *hotel* to the *Fukuoka International Congress Center* (5 min & JPY 600)

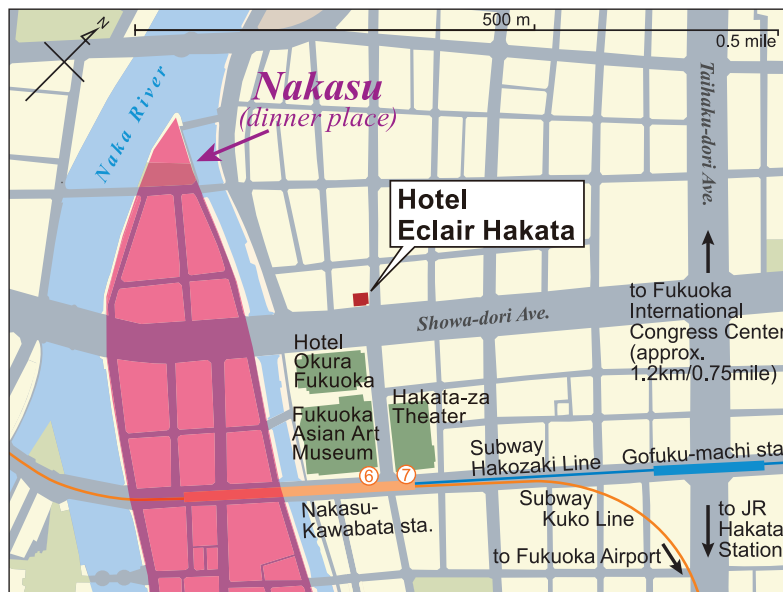

Taxi Information

Please print out and show the following Japanese instruction in this page to a taxi driver!

To the Fukuoka International Congress Center

福岡国際会議場までお願いします。(住所：福岡市博多区石城町 2-1)

To the Hotel Hakata Place

ホテル博多プレイスまでお願いします。(住所：福岡市博多区築港本町 3-16)

To the Hotel Eclair Hakata

ホテルエクレール博多までお願いします (住所：福岡市博多区須崎町 1-1)

To Fukuoka Airport (International / Domestic Terminal)

(International Terminal) 福岡空港国際線ターミナルまでお願いします。

(Domestic Terminal) 福岡空港国内線ターミナルまでお願いします。

Fukuoka International Congress Center

5th Floor

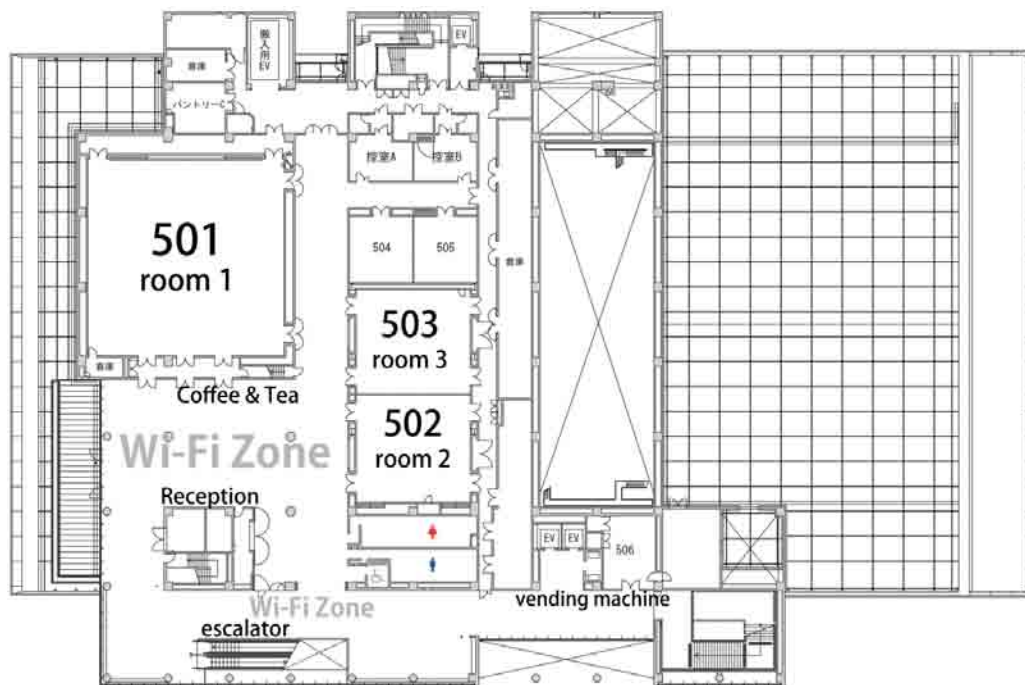

4th Floor

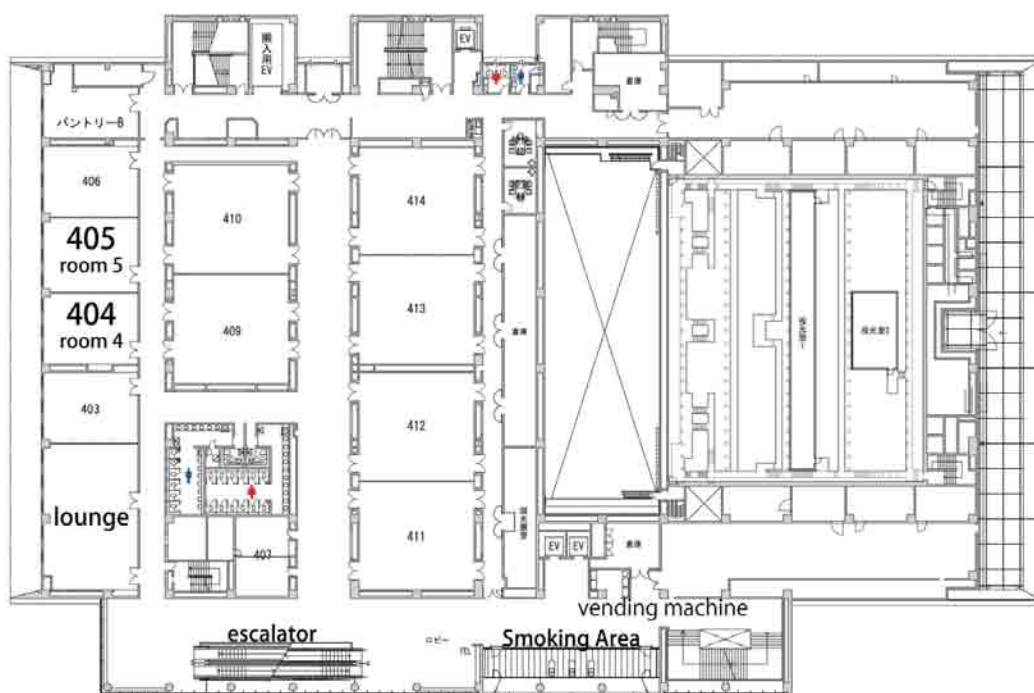

***Smoking Policy** The conference venue is non-smoking except for one smoking area on the 4th floor.

***Wi-Fi** Free Wi-Fi hotspots are provided on the 5th floor. No password is required.

5. Venue & Transport – Busan: 16 (Fri) November

Dongseo University Centum Campus



Address : 55 Centum Jungang-ro, Haeundae-gu, Busan, Korea

The Shuttle Bus departs from Toyoko-inn Busan Station 2 at 8:00 on 16 November to the conference venue

(Time taken: 30-40 min)

From Toyoko-inn Busan Station 2 (Metro + Walk)

Metro from Jungang-Dong station to Centum City station (change train at Seomyeon station from Line 1 to 2) (60min)

Walk from Centum City station (Exit No.6) to the venue (5 min)

From the Airport (Bus + Walk)

Bus from Gimhae Airport to BEXCO bus stop (50 min) - Airport Limousine Route 2 (Gimhae Airport – Centum City – Haeundae)

Walk from BEXCO bus stop to the venue (5 min)





Restaurants (Gwangbok-ro street, Nampo-dong and "Texas Street"): Many options are located 10-15 minute walk from Hotel Toyoko-inn Busan Station 2.

Accommodation in Busan



Hotel Toyoko-inn Busan Station 2

Address: 22-4,1Ga, Daechangdong jung-gu, 600-101 Busan , Korea

TEL: +82-(0)51-442-1045 FAX: +82-(0)51-442-1046

Check-in Time / 16:00; Check-out Time / 10:00

http://www.toyoko-inn.com/e_hotel/00178/index.html

30-minute from Gimhae Airport by taxi (KRW 17,000)

10-minute walk from Busan station

5-minute walk from Jungang-dong station on subway Line 1

Shuttle Bus to Gimhae Airport (17 November)

Depart from the hotel at

5:00 / 6:00 / 7:00 / 8:00 / 9:00 / 10:15 on 17 November

(time taken: 40 min)

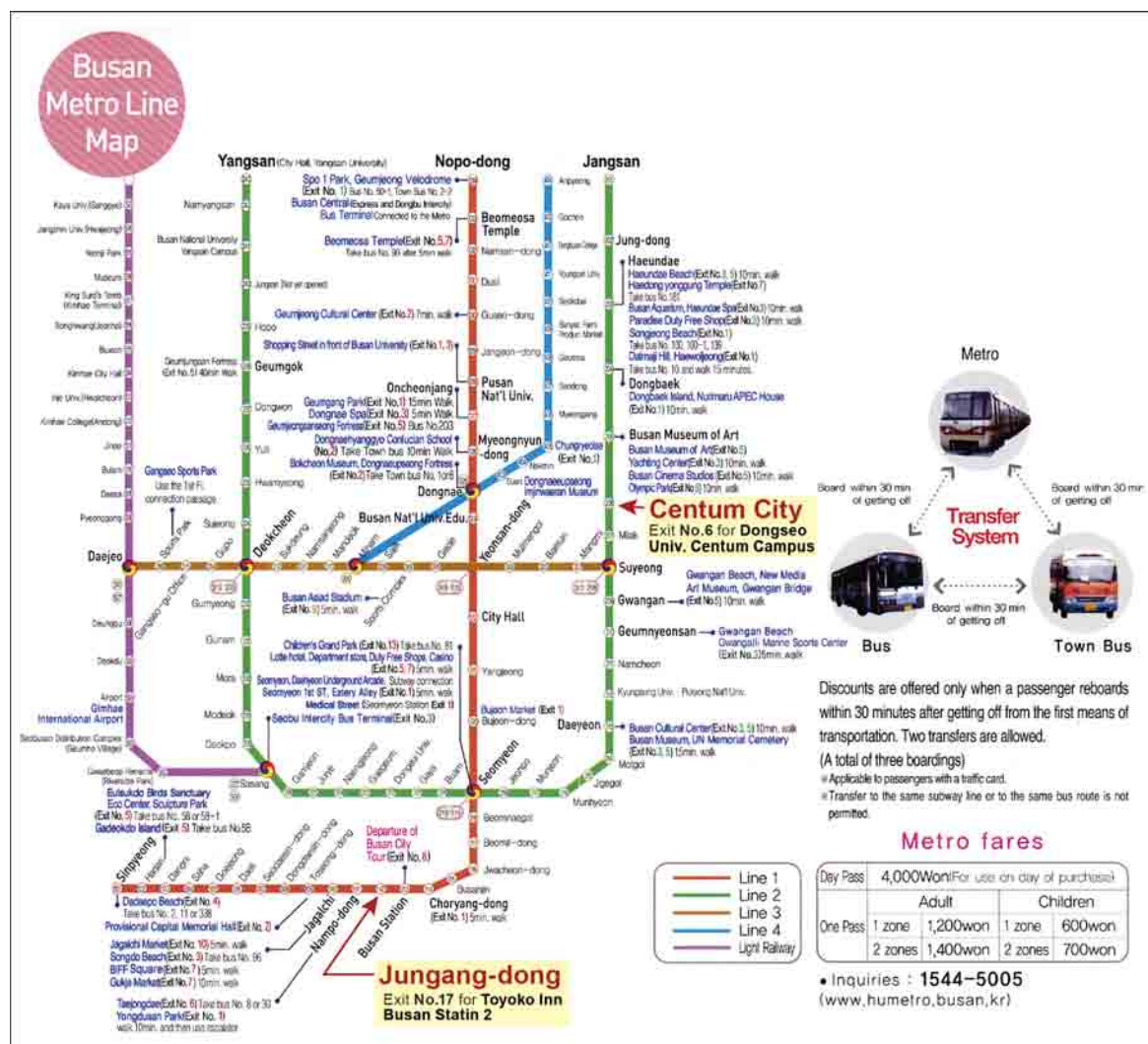
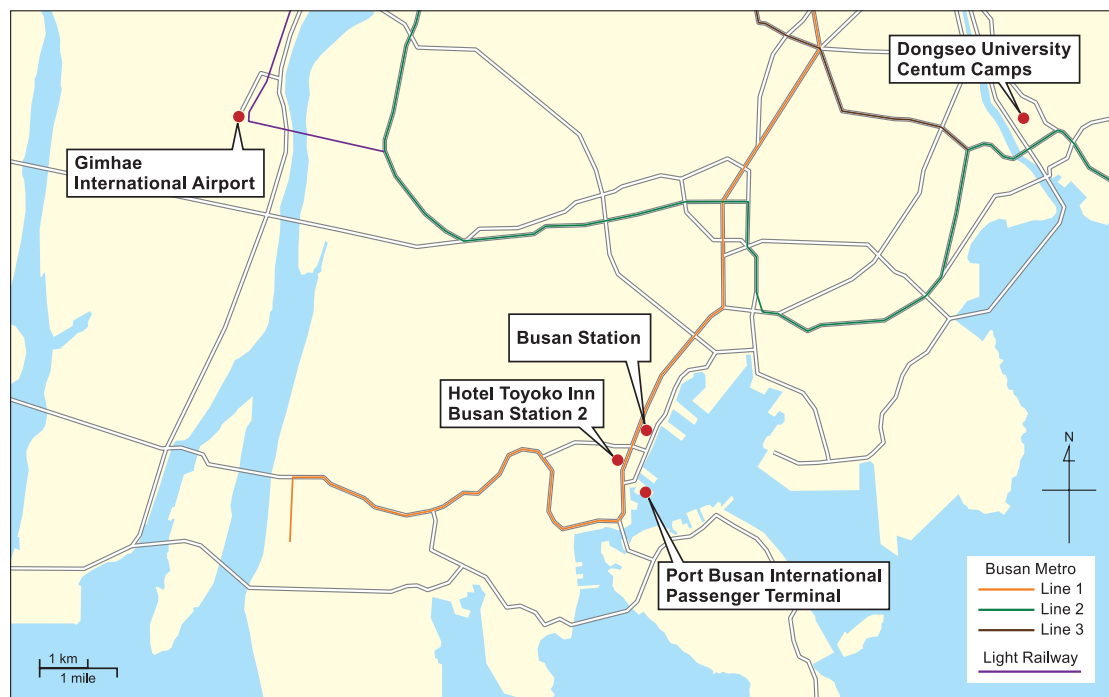

6. Lunch & Banquet: Fukuoka Session

Lunch: 13 (Tue) and 14 (Wed) November

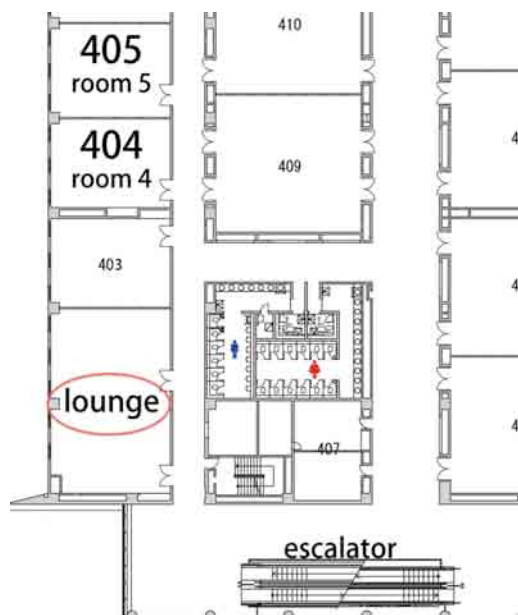

Lunch boxes will be provided in the 4th floor lounge (Room 401 & 402), **from 12:00 on 13 (Tue) November**, and **from 11:45 on 14 (Wed) November**.

Due to time limitations, participants can take their lunch to the afternoon sessions after picking them up.

Vegetarian and halal lunch boxes will be made available for those who requested in advance.

Banquet: 13 (Tue) November

The banquet is hosted by the Mayor of Fukuoka City, Soichiro TAKASHIMA

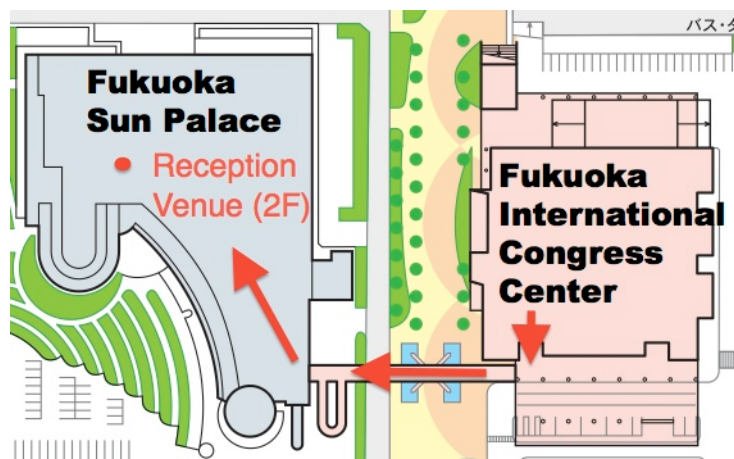

The welcome banquet will be held on the 1st day of BRIT, 13th November, starting at 19:30 in Fukuoka Sun Place, next to the conference venue.

Participants can easily walk from the conference venue to the reception venue through the 2F access-way. Our staff will guide participants to the reception venue after the final session.

7. Sumo Wrestling Spectating: 14 (Wed) November

Assembly time & location:

15:50 at the entrance/ground floor of the Fukuoka International Congress Center

Venue: Fukuoka Kokusai Center, located two doors from the International Congress Center

Time: 16:00-18:00 (Light meal will be provided)

*Reservations & Payments are required!

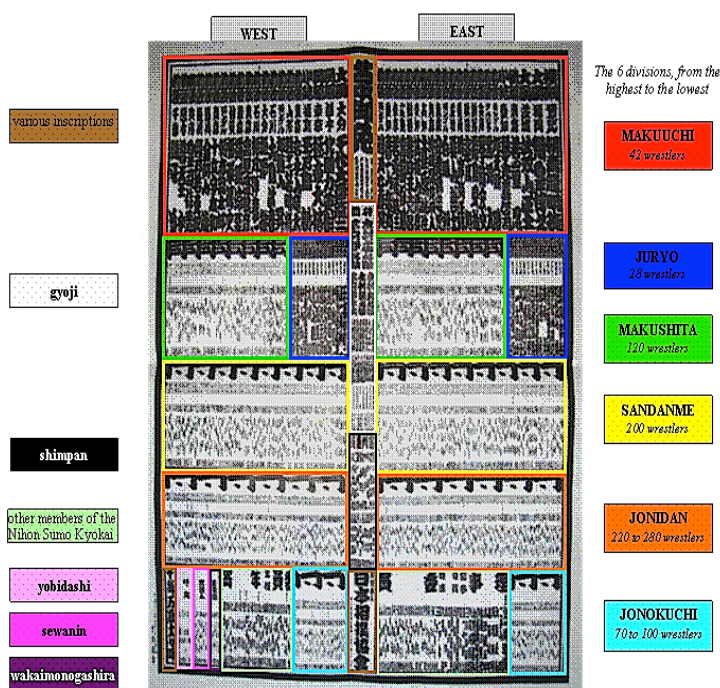

Sumo(相撲), Japan's national sport, is said to have originated in contests of strength between gods recorded in the ancient history called the Kojiki (古事記), and since antiquity has spread as a Shintō (神道) ritual. Its bouts have been popular since the Edo (江戸) period, and remain so today.

Wrestlers' rank and order are established by and published on official lists called *banzuke* (番付, as shown on the left), with the highest-ranking wrestler called the *yokozuna* (横綱) in the top division called *makuuchi* (幕内) being praised as a man of dignity as well as strength.

The key tournaments are held six times a year (Tokyo: Jan, May&Sept; Ōsaka: Mar; Nagoya: Jul; Fukuoka: Nov). Each match lasts fifteen days, and they decide the *banzuke* ranking within each class of wrestlers.



Sumo characters & useful vocabulary:

【Yobidashi】(呼出): Usher

【Gyouji】(行司): Sumo referee

【Rikishi】(力士): A sumo wrestler

【Shikona】(四股名): A rikishi's professional name

【Mage】(髷): A topknot

【Mawashi】(廻し): The belt-like garment rikishi wear

【Kesyō-Mawashi】(化粧廻し): A decorative mawashi with an embroidered, apron-like front.

【Dohyō】(土俵): The sumo ring, a packed earth circle used for no other sport, 4.55 meters (around 14 feet) in diameter.

【Torikumi】(取組み): Sumo Battle

【Kiyome no shio】(清めの塩): Salt is used to purify the dohyō and pray for a safe match.

【Shiko wo fumu】(四股を踏む): The shiko is a key gesture in sumo. When a rikishi enters the ring, he stands with his legs apart and knees bent. One after another, he lifts a leg high, claps his hand to his knee, and stomps the ground with all his might. This is called "stomping (fumu) the shiko." This action drives out evil.

【Shikiri】(仕切り): The two rikishi face each other at the centre of the ring, fists planted on the ground, in preparation for the match.

【Tachiai】(立合い): After a repeat shikiri, the rikishi meet each other's eyes, then leap up and collide.

【Gappuri Yotsu】(がっぷり四つ): A position in which rikishi are chest-to-chest with a tight two-handed grip on the other's mawashi.

【Kimari-Te】(決まり手): The winning move, causing the opponent to touch the ring with anything besides the bottom of his feet, or to be moved outside of the ring.

8. Musical “Tale of Tsushima”: 14 (Wed) November

Musical: Tale of Tsushima / presented by the Tsushima Citizen Theatrical Company “ISARIBI”

Organizers: BRIT XII–2012 Organizing Committee, Tsushima Citizen Theater Executive Committee

Co-organizer: The Cultural Association of Tsushima City

Support: Fukuoka City, Nishinippon Newspaper, Asahi Newspaper, Tsushima Newspaper

Date: Wednesday, November 14, 2012

Time: 18:30 Open / 19:00 Start / 20:45 End

Venue: Fukuoka City Children’s Science & Culture Center (2-5-27, Maizuru, Chuo-ku, Fukuoka)

Plot Summary:

The story begins in 1590, as Maria, the daughter of a Christian daimyo (feudal lord), Konishi Yukinaga, comes to Tsushima to marry Soh Yoshitoshi, the 19th feudal lord of the Tsushima domain. The marriage is a very happy occasion for the island. However, the marriage is planned as a political maneuver by Toyotomi Hideyoshi, whom Konishi trusted, in preparation for the conquest of Ming China.

In 1592, Hideyoshi commands all feudal lords in Japan to send their troops to Korea. Samurai generals such as Kato Kiyomasa and Fukushima Masanori commit all kinds of atrocities during the invasion of Korea. Even though Tsushima’s soldiers are ordered to be vanguards of the invasion, they try to find a way to make peace. The battles of Bunroku and Keicho last six years and the war ends shortly after Hideyoshi’s death. However, the war leaves much unrest in Japan. In 1600, the Battle of Sekigahara, also known as the Battle for the Sundered Realm, begins. The eastern army is led by Tokugawa Ieyasu, and the western army is led by Ishida Mitsunari. Since Tsushima and Konishi’s dominions are related by marriage, they fight on the side of the western army. Nevertheless, the war ends with a great victory for the eastern army, and Ieyasu establishes the Tokugawa shogunate. In contrast to Hideyoshi, the Tokugawa shogunate drastically change their policy and seek “peace” with Korea – a development of great consequence to Tsushima. The dominion’s fate hinges on making peace with Korea. Since Tsushima betrayed Korea once, it is hard for Korea to trust the dominion again. Tsushima sends its able vassals to Korea one after another as messengers but to no avail. Finally, Tsushima decides to alter the sovereign letter written by the Tokugawa shogun to negotiate and restore diplomatic relations with Korea. “The island will rule itself”. This seems to be the only way for Tsushima to survive.

The domain’s efforts are rewarded in 1607 when it welcomes the Korean king’s envoys to Tsushima. The large procession consists of 467 members. Tsushima’s intervention and hospitality for the Korean envoys establishes the foundation for friendship between the two nations. This history is indispensable when discussing Tsushima and is a crucial part of Japanese history.

This musical will allow you to experience this turbulent era in the history of Tsushima. The play is performed by the Tsushima municipal theater troupe, with the cooperation of a local choir, Japanese dance troupe, and Japanese drum group.

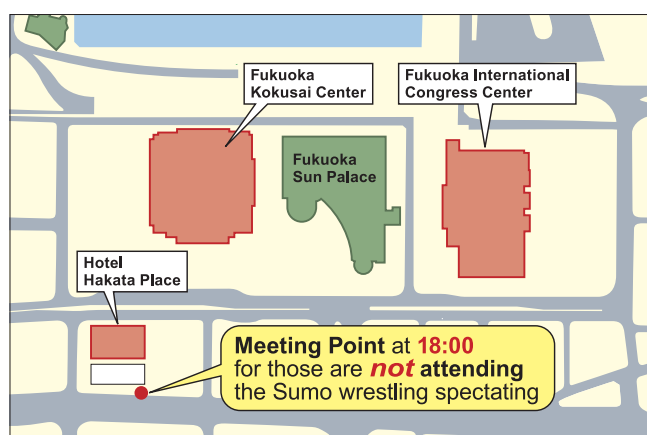

For those who also attend the Sumo Spectating: Our staff will take you to the Meeting Point after the Sumo will finish at 18:00.

For those who are **NOT attending the Sumo Spectating:** Please come to the Meeting Point on your own at 18:00 !

The Meeting Point is located around the Bus Stop “Hakata-Futo Iriguchi (Wharf)”.

9. Tsushima Field Trip: 15 (Thur) November

Tsushima Island is among the most “peaceful” maritime border regions of Japan. This island is located 49.5 km southeast of Busan and 130 km northwest of Fukuoka. Through this field trip and a talk given by the Mayor of Tsushima City, Mr. Yasunari TAKARABE, participants of BRIT XII 2012 Fukuoka/Busan will have a great opportunity to experience the reality of the maritime border between Japan and Korea. Below are the details and itinerary regarding our Tsushima Field Trip.

Participants of the field trip should be at the waiting lounge of the Hakata Pier (Hakata Futo) Terminal 1 “Bayside Place Hakata” at 7:30 AM.

We first travel by water on a jetfoil “Beetle” from Port Hakata to Port Izuhara, located in the southern part of Tsushima Island, and go northward by bus to Port Hitakatsu in the north-eastern edge of Tsushima. At Port Hitakatsu we will go through passport control and again travel by water on the same jetfoil to the hyper-modernized Port of Busan, the southern maritime gateway of Korea.

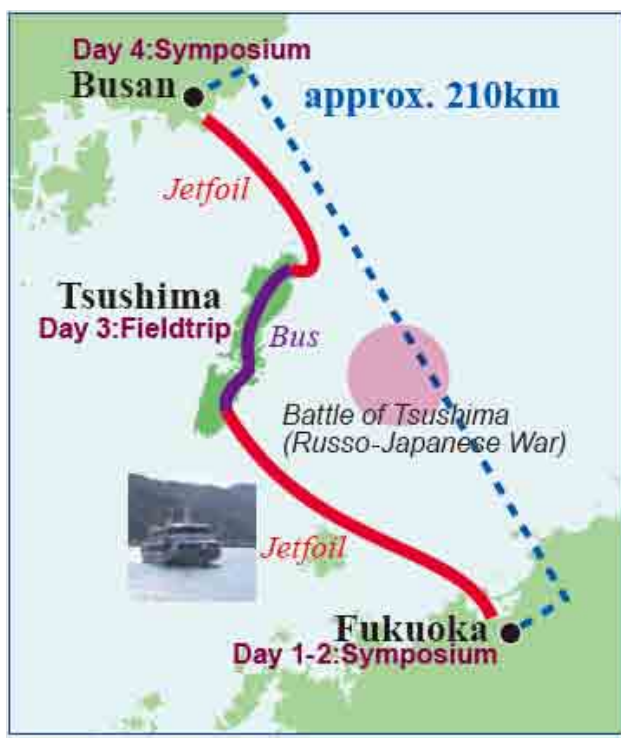

Itinerary

- 07:30** Meet at Hakata Pier (Hakata Futo) Terminal 1 “Bayside Place Hakata”
(Registration & boarding the chartered Jetfoil “Beetle,” operated by JR Kyusyu Jet Ferry Inc.)
- 08:30** Departure from *Port Hakata*
(A documentary on Tsushima, produced by Hokkaido University GCOE Program, will be shown on the jetfoil)
- 10:15** Arrival at *Port Izuhara*
(Transfer to bus routes)
- 11:25** Visit the Watatsumi Shrine
(Lunch on the bus or at the shrine)
(We will enjoy the beautiful coastal landscape of central Tsushima and experience Japanese spiritual culture)
- 12:20** A talk given by the Mayor of Tsushima City, Mr. Yasunari TAKARABE, at Tsushima City Public Hall
Notice! No food or drinks are allowed in the Hall!

- 14:50** Visit Tonosaki Park
(We will see three memorials from the Battle of Tsushima during the Russo-Japanese War, 1905)
- 15:30** Arrival at *Port Hitakatsu* (go through Japanese passport control)
- 16:15** Departure from *Port Hitakatsu* on the “Beetle” (A documentary on Busan will be shown on)
- 17:25** Arrival at the Port of Busan
(We will go to our hotel, “Toyoko-Inn Busan Station 2,” by chartered buses)



Pathway from Hotel “Hakata Place” to Hakata Pier Terminal 1

* Participants staying at Hotel Éclair Hakata are advised to take a taxi to “Bayside Place Hakata” since there is no direct bus route from the hotel to the Hakata Pier. It will take about 10 min by taxi.

Notice!

- ✓ Please don't forget **your printed name badge**, which each participant receives at the Conference registration desk in Fukuoka. To confirm the number of passengers, your printed name badge grants access to board the “Beetle”.
- ✓ During the bus trip, you can leave all your belongings on the jetfoil “Beetle” **except your passport and valuables**. Your passport is necessary for passport control at Port Hitakatsu. We will travel on the same jetfoil to the Port of Busan.
- ✓ Your lunch (sandwiches) will be distributed at Port Izuhara. You can have your lunch on the bus or at the Watatsumi Shrine.

If you feel sick or have certain problems, please do not hesitate to ask the Conference staff for help.

Information on foreign currency exchange:

“Yen” is the currency used in Japan and “Won” in Korea. You are advised to exchange currency from yen to won at the Port of Busan or in Busan City, because there is no currency exchange at either Hakata Pier Terminal 1 or Port Hitakatsu. You will find many banks and currency exchange bureaus in central Busan, where you can exchange major currencies such as U.S. and Canadian dollars, euros, yen, yuan and rubles to Korean won. Note that not all currencies can be exchanged for won. There is no currency exchange service at Hotel Toyoko Inn Busan Station 2. If you have credit cards (VISA, Master Cards etc.) or Cirrus, you can withdraw cash (wons) from bank ATMs, available 24 hours a day.

10. Conference Programme

DAY 1 (Tue, 13 November) Venue: Fukuoka International Congress Center

08:00-	Registration
09:00-12:00	Morning Plenary
12:00-12:30	Lunch Break
12:30-14:00	Session 1.1-1.3
13:30-17:00	Open Event for Fukuoka citizens (with simultaneous English interpretation)
14:00-14:15	Coffee Break
14:15-15:45	Session 1.4-1.6
15:45-16:00	Coffee Break
16:00-17:30	Session 1.7-1.9
17:30-17:35	Coffee Break
17:45-19:15	Session 1.10-1.13
19:30-21:00	Welcome Banquet hosted by the Mayor of Fukuoka City, Soichiro Takashima

DAY 2 (Wed, 14 November) Venue: Fukuoka International Congress Center

08:00-	Registration
08:30-11:45	Session 2.2/2.6
08:30-10:00	Session 2.1, 2.3-2.4
10:00-10:15	Coffee Break
10:15-11:45	Session 2.5, 2.7-2.8
11:45-12:30	Lunch Break
12:30-14:00	Session 2.9-2.12
14:00-14:15	Coffee Break
14:15-15:45	Session 2.13-2.16
16:00-18:00	Sumo Wrestling Spectating (Optional) at the Fukuoka Kokusai Center
19:00-21:00	Musical "Tale of Tsushima" at the Fukuoka City Children's Science & Culture Center

DAY 3 (Thu, 15 November) Tsushima Field Trip

DAY 4 (Fri, 16 November) Venue: Dongseo University, Centum Campus

08:00-	Departure from the Hotel (Shuttle Bus)
09:30-11:00	Session 3.1-3.3
11:00-11:15	Coffee Break
11:15-12:45	Session 3.4-3.7
12:45-13:45	Lunch Break
13:45-15:15	Session 3.8-3.11
15:15-15:30	Coffee Break
15:30-16:00	Special Lecture
16:00-16:20	Coffee Break
16:20-18:40	Closing Plenary
19:00-	Farewell Reception hosted by the President of Dongseo University, Jekuk CHANG

DAY 1 (Tue, 13 November)

Opening Remarks & Setting the Scene	9:00-10:00 / Room 1 (501)
<ul style="list-style-type: none"> ● Hiroshi Saeki (President of Hokkaido University, Japan) ● Takatoshi Matsubara (Director of the Research Center for Korean Studies, Kyushu University) Introduction to the Fukuoka-Busan Supra-Regional Economic Zone ● Akihiro Iwashita (BRIT XII coordinator) BRIT XII: Challenges and Perspectives 	
Open Borders: "Border Studies: Past and Present Challenges in the Development of the Field"	10:00-12:00 / Room 1 (501)
<p>Moderator: Tony Payan (University of Texas at El Paso, US)</p> <p>Panelists:</p> <ul style="list-style-type: none"> ● Liam O'Dowd (Queen's University Belfast, Northern Ireland, UK) ● Michel Foucher (Institute for Higher National Defense Studies, France) ● James W. Scott (University of Eastern Finland, Finland) ● Vladimir Kolosov (Institute of Geography RAS, Russia) ● Kathleen Staudt (University of Texas at El Paso, US) ● Yuzo Yabuno (Kyushu University, Japan) <p>This moderated round table, with some of the most prominent border scholars from around the world, will evaluate 100 years of border studies, with particular emphasis on developments over the last three decades; the current state of border studies; and the steps necessary to take this multidisciplinary field to the next stage. The purpose of the panel is to draw out some of the most important empirical and theoretical lessons from our past and evaluate the relevancy of the border studies community for understanding a world where borders are being constructed even as globalization proceeds apace. This roundtable explores some of the difficulties that border scholars confront in carrying out empirical research, building theory, and developing relevance in public policy, as well as strategies to move the field forward in relation to the complicated reality of both material and immaterial borders.</p>	
Special Open Event for Fukuoka citizens "The Formation of the Fukuoka-Busan Supra-Regional Economic Zone Symposium" (with simultaneous English interpretation for the foreign audience)	13:30-17:30 / Room 1 (501)
<p>"The Formation of the Fukuoka-Busan Supra-Regional Economic Zone Symposium" is a symposium to address the goal of embarking on a new era of supra-regional economic zones through combining the efforts and bilateral cooperation of the cities of Fukuoka and Busan. The symposium will feature a keynote lecture by Prof. Kang Sang-jung from the University of Tokyo. A debate by the students of both cities will be also carried out.</p> <p>On behalf of the Organizing Committee, we cordially invite and look forward to active participation of the citizens.</p> <ul style="list-style-type: none"> ▪ Symposium <ul style="list-style-type: none"> – Keynote speech on "<i>Challenges to the Pan Yellow Sea metropolitan area due to the formation of Fukuoka-Busan supra-regional economic zone</i>" by Prof. Kang Sang-jung (director of Center for Contemporary Korean Studies, Interfaculty Initiative in Information Studies, the University of Tokyo, Japan) – Debate by the students of Fukuoka (Kyushu University) and Busan (Dongseo University) on "<i>Improvement of the cities' attractiveness due to the increased exchange of population</i>" <p>Moderator: Kaoru Izumi (Kyushu University, Japan)</p>	

Kang Sang-jung is Professor at the Interfaculty Initiative in Information Studies, University of Tokyo. He was born in 1950 and grew up in Kumamoto. He specialises in political science and history of political thought, and has written extensively on various subjects for many journals and newspapers. His major works include "Beyond Orientalism" (Iwanami, 1996), "The Perspective of Globalization" (Iwanami, 2001, co-authored with Yoshimi Shunya), and "Nationalism" (Iwanami, 2001).

Session 1.1 Border Demarcation	12:30-14:00 / Room 3 (503)
<p>Moderator & Commentator: Anton Gosar (University of Primorska, Slovenia)</p> <ul style="list-style-type: none"> ● Assel Bitabarova (Hokkaido University, Japan) A Comparative Study on the Central Asian-Chinese Border Settlement ● Hari Bansh Jha (Center for Economic and Technical Studies, Nepal) Nepal's Border Relations with India and China ● Alexander Bukh (University of Tsukuba, Japan) Territorial Disputes and Civil Society in Japan and South Korea ● Nivedita Das Kundu (Indian Council for Social Science Research, India) Japan-Russia Territorial Dispute over the Kuril Islands 	
Session 1.2 Minorities & Cross Border Challenges	12:30-14:00 / Room 4 (404)
<p>Moderator & Commentator: Kathleen Staudt (University of Texas at El Paso, US)</p> <ul style="list-style-type: none"> ● Yuka Mizutani (Toyo University, Japan) Exhibiting Visible and Invisible Aspects of Cultures and Histories on the Borderland: Representation of the Yaqui Culture and History in Museums ● Ivan Peshkov (Adam Mickiewicz University, Poland) People in the Shadow of Empire Bordering. New Evenki Transborder Nationalism in North-Eastern Asia ● Mirza Zulfiqur Rahman (Indian Institute of Technology, India) Territory, Tribes, Turbines: Local Community Perceptions and Responses to Indian Infrastructure Building along the Sino-Indian Border in Arunachal Pradesh ● Ladislav Lesnikovski (Tokyo University of Foreign Studies, Japan) Borderland Identities: The Slavic Muslim Minorities in Kosovo and Macedonia 	
Session 1.3 Home in the Borderland	12:30-14:00 / Room 5 (405)
<p>Moderator & Commentator: David Wolff (Hokkaido University, Japan)</p> <ul style="list-style-type: none"> ● Svetlana Paichadze (Hokkaido University, Japan) Voices of the Borderland Community: The Identities and Educational Issues of "Repatriates" from Sakhalin ● Hyun Mooam (Hokkaido University, Japan) North Korean—South Korean Disputes over the "Home" of Sakhalin Koreans ● Philip Seaton (Hokkaido University, Japan) Memories Beyond Borders: Karafuto Sites of Memory in Hokkaido ● Masatoshi Miyashita (Hokkaido University, Japan) "Homecoming" Visits to Karafuto 	
Session 1.4 Comparing Land and Sea Borders	14:15-15:45 / Room 3 (503)
<p>Moderator & Commentator: Vladimir Kolosov (Institute of Geography, Russian Academy of Sciences, Russia)</p> <p>Commentator: Paul Richardson (Far Eastern Federal University, Russia)</p> <ul style="list-style-type: none"> ● Shuqin Gao (University College London, UK) 	

<p>The Resolution of Boundary Debate as the Beginning for Strategic Cooperation Between China and SOC Countries</p> <ul style="list-style-type: none"> ● Christopher Len (Institute for Security and Development Policy, Sweden) China's Evolving Self-Identity and Maritime Strategy: Implications for the East and South China Seas Disputes ● Mason Richey (Hankuk University of Foreign Studies, Korea) The EU's Possible Mediator Role in Asia-Pacific Maritime Border Disputes
--

Session 1.5 Environment	14:15-15:45 / Room 4 (404)
<p>Moderator: Decha Tangseefa (Thammasat University, Thailand)</p> <p>Commentator: Aysun Uyar (Research Institute for Humanity and Nature, Japan)</p> <ul style="list-style-type: none"> ● Anna Katharina Grichting Solder (Qatar University, Qatar) Landscapes of Energy in the Arabian Gulf: Qatar's Borderscapes: Designing Ecological Peace ● Fuminori Kawakubo (Chuo Gakuin University, Japan) & Junji Shiraishi (Esri Japan Corporation, Japan) The Fukushima Daiichi Nuclear Disaster: Perspectives from The Border Areas ● Furugzod Usmonov (Tajik National University, Tajikistan) Transboundary Rivers in Central Asia: Conflicts, Prevent, Resolution and Management 	

Session 1.6 Conflicts and Economic Changes: Africa	14:15-15:45 / Room 5 (405)
<p>Moderator & Commentator: Yuji Ankei (Yamaguchi Prefectural University, Japan) & Takako Ankei (Yamaguchi University, Japan)</p> <ul style="list-style-type: none"> ● Gordon C. Mwangi (Shikoku Gakuin University, Japan) The Historical Origins of Border Problems Between Somali and Her Neighbours ● Shinichi Takeuchi (Institute of Developing Economies, Japan) Dominance Beyond the Border (1): Rwanda-DR Congo Relations and Their Impacts on Rwanda's Political Economy after the 1990s ● Masato Sawada (Kyoto Seika University, Japan) Dominance Beyond the Border (2): Uganda-DR Congo Relations since 1990's with Special Reference to Oil Discovered in the Lake Albert Area ● Jean-Claude Maswana (JICA-Research Institute, Japan) Africa's Economic Landscape and Rising China: Trends and Issues 	

Session 1.7 JAPAN SPECIAL: Voice of Borderlands in Japan I: Security and Resources (with interpretation of Japanese and English)	16:00-17:30 / Room 2 (502)
<p>Moderator & Commentator: Koji Furukawa (Chukyo University, Japan)</p> <ul style="list-style-type: none"> ● Akihiro Sado (Chukyo University, Japan) Effectiveness of Japan's Defense Policy in its Borderlands ● Keiyu Kohama (Taketomi Town Office, Japan) Local Government's Ocean Policy I: A Case of Taketomi Town, Okinawa ● Minoru Kubo (Goto City Office, Japan) Local Government's Ocean Policy II: A Case of Goto City, Nagasaki ● Ryoichi Honda (The Hokkaido Shimbun Press, Japan) Japan's Northern Territory Issues 	

Session 1.8 Migration	16:00-17:30 / Room 3 (503)
<p>Moderator & Commentator: Machiko Hachiya (Kyushu University, Japan)</p> <ul style="list-style-type: none"> ● Paul Fryer (University of Eastern Finland, Finland) 	

<p>Central Asian Labour Migrants to Russia: Employment Agencies vs. Informal Job Search Networks</p> <ul style="list-style-type: none"> ● Botagoz Rakisheva (Institute for Social and Political Studies, Kazakhstan) & German Kim (Kazakhstan Institute for Strategic Studies, Kazakhstan) <p>The Trends of Migrations, Conflicts and Cooperation in the Borderland of Contemporary Kazakhstan</p> <ul style="list-style-type: none"> ● Alena Nikolaevna Prizhennikova & Maria Rashchukova (Financial University under the Government of the Russian Federation, Russia) <p>Migration Policy of the Russian Federation: Approaches (Mechanisms and Methods) of Solution</p> <ul style="list-style-type: none"> ● Andrew Wolman (Hankuk University of Foreign Studies, Korea) <p>North Korean Asylum Seekers and Dual Nationality</p>

Session 1.9 City I	16:00-17:30 / Room 4 (404)
<p>Moderator & Commentator: Liam O'Dowd (Queen's University Belfast, Northern Ireland, UK)</p> <ul style="list-style-type: none"> ● Pertti Joenniemi (University of Eastern Finland, Finland) <p>Alike But Not Fully Alike: On the Liminality of Twin Cities</p> <ul style="list-style-type: none"> ● Takashi Yamazaki (Osaka City University, Japan) <p>Koza as a Borderland: The Reconstruction of Militarized Places, Memories, and Identities</p> <ul style="list-style-type: none"> ● Christophe Sohn (CEPS/INSTEAD, Luxembourg) <p>European Functional Border Regions: An Urban Potential Typology</p> <ul style="list-style-type: none"> ● Albert Wong (Macao Ricci Institute, China) <p>Border Issues in Postcolonial Macao</p>	

Session 1.10 JAPAN SPECIAL: Voice of Borderlands in Japan II: International Exchanges (with interpretation of Japanese and English)	17:45-19:15 / Room 2 (502)
<p>Moderator & Commentator: Koji Furukawa (Chukyo University, Japan)</p> <ul style="list-style-type: none"> ● Yuji Suzuki (Nagasaki Wesleyan University, Japan) <p>Transnational Island's Exchange: Cases of Tsushima and Goto Islands</p> <ul style="list-style-type: none"> ● Naoki Arai (Fukuoka Asian Urban Research Center, Japan) <p>Transnational Regional Exchange between Fukuoka, Tsushima and Busan</p> <ul style="list-style-type: none"> ● Miran Lee (Tsushima High School, Japan) <p>History of Korean Language Education in Tsushima</p> <ul style="list-style-type: none"> ● Hideshi Sato (Wakkanai City Office, Japan) <p>Transnational Regional Exchange between Wakkanai City and Sakhalin</p>	

Session 1.11 Technology & International Relations	17:45-19:15 / Room 3 (503)
<p>Moderator & Commentator: Christopher Len (Institute for Security and Development Policy, Sweden)</p> <ul style="list-style-type: none"> ● Monika Chansoria (Centre for Land Warfare Studies, India) <p>Defying Borders: Cyberspace and East Asian Security</p> <ul style="list-style-type: none"> ● Zeev Zivan (Ben Gurion University, Israel) <p>Between Sederot and the "Green Line"</p> <ul style="list-style-type: none"> ● Hidefumi Nishiyama (University of Warwick, UK) <p>Biometrics as Borderland: A Methodological Approach to Materiality</p> <ul style="list-style-type: none"> ● Tomohiro Yara (Freelance Writer) <p>The US Military Presence in Japan's Outlying Territories: Okinawa</p>	

Session 1.12 City II	17:45-19:15 / Room 4 (404)
<p>Moderator & Commentator: Michel Foucher (Institute for Higher National Defense Studies, France)</p> <ul style="list-style-type: none"> ● Jonathan Burrow (University of Oulu, Finland) A Night in Shenzhen; Freedom and Status is Just over the Fence ● Sergey Tkachev (Far Eastern Federal University, Russia) The Origin of Vladivostok in Context of Geopolitical History ● Frédéric Durand (CEPS/INSTEAD, Luxembourg) & Jen Nelles (Urban Affairs and Planning Hunter College) Functioning of Cross-border Governance within the Lille-Kortrijk-Tournai Eurometropolis through the Lens of the Cross-border Public Transportation Issue ● Adam Ploszaj (University of Warsaw, Poland) City Twinning in European Cross-Border Regions 	

Session 1.13 Diasporas & Minorities	17:45-19:15 / Room 5 (405)
<p>Moderator & Commentator: Joni Virkkunen (University of Eastern Finland, Finland)</p> <ul style="list-style-type: none"> ● Jianying Xu (Research Center for the History and Geography of China's Borderlands, Chinese Academy of Social Sciences, China) The Uygur Diaspora in Central Asia: A Historical and Present Review ● Taisho Nakayama (Japan Society for the Promotion of Science, Japan) Exile to Motherland and Exile to Hometown: Repatriate from Karafuto and Remaining in Sakhalin ● Keiji Sato (Hokkaido University, Japan) "Romanians" Beyond EU Border: Is Romania Heartland or Economic Asylum for Moldovans and Romanian Diaspora in Ukraine? ● Haruka Miyazaki (Japan Society for the Promotion of Science, Japan) The Concepts of Land in the Polish Zionism in the Partition Period 	

DAY 2 (Wed, 14 November)

Session 2.1 Social Sciences, Technologies and Politics at the Border	8:30-10:00 / Room 2 (502)
<p>Moderator: Anne-Laure Amilhat Szary (Université Joseph Fourier, France)</p> <p>Commentator: Frédéric Giraut (Université de Genève, Switzerland)</p> <ul style="list-style-type: none"> ● Anne-Laure Amilhat Szary (Université Joseph Fourier, France) & Cédric Parizot (Centre National de la Recherche Scientifique(CNRS), IREMAM, France) Introduction : 21st Century Borders Through the Lens of Transdisciplinarity ● James W. Scott (University of Eastern Finland, Finland) (EU)-European Border Research and the Re-Framing of European Borders ● Clochard Olivier Jacques (Centre National de la Recherche Scientifique (CNRS), France) Mapping Control without Borderlines ● Amaël Cattaruzza (Saint Cyr Coëtquidan Military School, France) On-board Borders? 	
Session 2.2/2.6 Living with (Un)familiarity in Borderlands	8:30-11:45 / Room 3 (503)
<p>Moderator & Commentator: Bas Spierings (Utrecht University, Netherlands) & Martin van der Velde (Radboud University Nijmegen, Netherlands)</p> <ul style="list-style-type: none"> ● Bas Spierings (Utrecht University, Netherlands) & Martin van der Velde (Radboud University Nijmegen, Netherlands) Living with (Un)familiarity: Shopping in the Dutch-German Borderland ● Henrik Dorf Nielsen (University of Eastern Finland, Finland) Friend or Foe? —Russia from a Finnish Perspective ● Alexandre Izotov (University of Eastern Finland, Finland) Constructing (Un)familiarity: Role of Tourism in Identity and Region Building at the Finnish-Russian Border ● Marek Wieckowski (Institute of Geography and Spatial Organization, Polish Academy of Sciences, Poland) Tourism Development in the Borderlands in Central Europe ● Werner Breitung (Sun Yat-sen University, China) Post-colonial (Un)familiarity as a Factor in the Integration Process of Macau and Hong Kong ● Indrė Balčaitė (University of London, UK) Absent but Real? Perceptions of the Thai-Burmese Border by the Inhabitants of Mae Sot, Thailand ● Stanisław K. Domaniewski (University of Eastern Finland, Finland) Development Potential of Building Closer Cultural Ties in the Kaliningrad Oblast / Warmia Mazury Region 	
Session 2.3 De-bordering Environmental Change: Northeast Asia	8:30-10:00 / Room 4 (404)
<p>Moderator: Makoto Taniguchi (Research Institute for Humanity and Nature, Japan)</p> <ul style="list-style-type: none"> ● Aysun Uyar (Research Institute for Humanity and Nature, Japan) & Müge Kinacıoğlu (Hacettepe University, Turkey) Changing Concepts of Human Security from Traditional to Environmental Direction along Borderlands ● Makoto Taniguchi (Research Institute for Humanity and Nature, Japan) Changing Concept of Water Boundaries and Security in East Asia ● Seiya Nagao (Kanazawa University, Japan) Changing Concept of Material Cycle and its Boundaries ● Udibowo Ciptomulyono (PT PLN Geothermal, Indonesia) Changing Concept of Energy Production and Use with Human Boundaries 	

<ul style="list-style-type: none"> Yasunori Hanamatsu (Hokkaido University, Japan) National and Regime Borders in Ecosystem Management: The Case of the Amur-Okhotsk Ecosystem

Session 2.4 Land, River and Sea	8:30-10:00 / Room 5 (405)
<p>Moderator: Carl Grundy-Warr (National University of Singapore, Singapore)</p> <ul style="list-style-type: none"> Shaun Lin (University of Wollongong, Australia) Shaping New Spaces at the Coasts: The Impacts and Implications of Maritime Joint Development in the Gulf of Thailand Ming Li Yong (National University of Singapore, Singapore) Eco-scapes and Borderscapes: Transforming and Re-thinking the Commons of the Mekong Region Carl Grundy-Warr & Wei Jun Chin (National University of Singapore, Singapore) Geopolitical History and Contemporary Contested Geo-body Frontiers at Mae Hong Son Province: A Tale of Two Foreign Ethnic Groups Shaun Lin (University of Wollongong, Australia) The 4th Thai-Lao Friendship Bridge: "Pattanaa" GMS or "Pattanaa" Chiang Khong? 	

Session 2.5 Borders studies across disciplinary and methodological boundaries	10:15-11:45 / Room 2 (502)
<p>Moderator: Cédric Parizot (Centre National de la Recherche Scientifique(CNRS), IREMAM, France)</p> <p>Commentator: Tony Payan (University of Texas at El Paso, US)</p> <ul style="list-style-type: none"> Gabriel Popescu (Indiana University, US) Producing Precarious Borders Cédric Parizot (Centre National de la Recherche Scientifique(CNRS), IREMAM, France) From Work Permits Trafficking to Graphic Design: Remapping Informal Network between the Occupied Palestinian Territories and Israel (2005-2012) Anne-Laure Amilhat Szary (Université Joseph Fourier, France) Watching Borders to see the World: from Non-representational Theories to Art- Science Interactions Jean Cristofol (School of Art Aix en Provence, France) Representation of Borders, Art and Technologies? 	

Session 2.7 (B)ordering, Lighting and Tomorrow-ing	10:15-11:45 / Room 4 (404)
<p>Moderator: Decha Tangseefa (Thammasat University, Thailand)</p> <p>Commentator: Akihiro Hirayama (Hokkaido University, Japan)</p> <ul style="list-style-type: none"> Decha Tangseefa (Thammasat University, Thailand) Light in the Dark: "The Political" of the Exception along the Spaces of Exception Kwanchewan Buadaeng (Chiang Mai University, Thailand) Buddhist Movements along the Thai-Myanmar Frontier Narumon Arunotai (Chulalongkorn University, Thailand) Nourishing Multiculturalism? Shirley Worland (Thammasat University, Thailand) Glocal Influence of Karen Identity on the Thai-Burma Border 	

Session 2.8 Muslim Borderlands in post 9.11 Southeast Asia	10:15-11:45 / Room 5 (405)
<p>Moderator: Ken Miichi (Iwate Prefectural University, Japan)</p> <p>Commentator: Maho Sato (Sasakawa Peace Foundation, Japan)</p> <ul style="list-style-type: none"> Jamhari (State Islamic University (UIN), Indonesia) 	

<p>Islam in post 9.11 Indonesia</p> <ul style="list-style-type: none"> ● Ismaillutfi Japakiya (Yala Islamic University, Thailand) <p>Islam in Southern Thailand</p> <ul style="list-style-type: none"> ● Soliman Melchor Santos (Philippine Judiciary) <p>Impact of the "Global War on Terror" on the Peace Process with the Moro Islamic Liberation Front</p>
--

Session 2.9 Inside-Outside	12:30-14:00 / Room 2 (502)
<p>Moderator & Commentator: Henk van Houtum (Radboud University Nijmegen, Netherlands)</p> <ul style="list-style-type: none"> ● Corey Johnson (University of North Carolina, US) Re-making "Inside-Outside" at the Margins of the New Europe: the Case of Bulgaria-Turkey ● Andrew Burrige (Durham University, UK) Frontex in Greece: Immigration Control at the External Boundaries of the EU ● Jayita Ray (Independent International Affairs Researcher) Borderland Voices: Reframing the Border Discourse between India and Bangladesh ● Sylwia Maria Olejarz (Cardinal Stefan Wyszyński University, Poland) Bodies Beyond the Borders: The Study on Organ Trafficking in CIS Countries 	

Session 2.10 Meta Spaces	12:30-14:00 / Room 3 (503)
<p>Moderator & Commentator: So Yamane (Osaka University, Japan)</p> <ul style="list-style-type: none"> ● Joni Virkkunen (University of Eastern Finland, Finland) Controlled, Managed, and Crossed: Ambivalent Everyday Borders of the Securitized Ferghana Valley ● Maciej Smetkowski & Tymoteusz Wronka (University of Warsaw, Poland) Carpathian Euroregion from the Perspective of Economic Cooperation in Peripheral Regions ● Gulmira Sultangaliyeva (Al-Farabi Kazakh National University, Kazakhstan) Novoileksk Line as the Boundary of Asia and Europe in the Context of Historical Time ● Anani Lazare Sossou-Agbo (Université de Grenoble, France) Weight of Borders in West-African Economic Space 	

Session 2.11 Cross-border I	12:30-14:00 / Room 4 (404)
<p>Moderator: Keiko Tamura (University of Kitakyushu)</p> <p>Commentator: Alexander Bukh (University of Tsukuba, Japan)</p> <ul style="list-style-type: none"> ● Sheila Delhumeau Rivera (Universidad Autónoma de Baja California, Mexico) Transboundary Intergovernmental Relations. Proposal of an Analytical Tool to Paradiplomacy and Borderwork: Scope, Opportunities and Challenges of Non-Understand the Interactions in the Mexico-US Border ● Yasuhiro Doi (Nagoya University, Japan) Regional Cooperation for Cross-Border Commuting –Challenge of Tri-national Region: Oberrhein– ● Jarmo Kortelainen (University of Eastern Finland, Finland) Resource Communities in Mobile, Fluid and Semi-permeable Borderlands 	

Session 2.12 Cross-border II	12:30-14:00 / Room 5 (405)
<p>Moderator & Commentator: Shinkichi Fujimori (Hokkaido University, Japan)</p> <ul style="list-style-type: none"> ● Jussi Laine (University of Eastern Finland, Finland) Paradiplomacy and Borderwork: Scope, Opportunities and Challenges of Non-state Dialogue across the Finnish-Russian Border 	

- Alina Novopashina (Amur State University, Russia)
The Effect of the Border on the Flows of Foreign Direct Investments: Evidence from Russian and Chinese Border Regions
- Joe Thomas Karackattu (Independent Researcher, India)
A Case for Pursuing Spatial Agglomeration Economies at the India-China Border
- Frédéric Durand & Christophe Sohn (CEPS/INSTEAD, Luxembourg)
Cooperation vs. Competition: The Logics Underlying the Construction of Cross-border Metropolitan Regions in Europe

Session 2.13 Shifting Borders	14:15-15:45 / Room 2 (502)
Moderator & Commentator: Tetsuro Chida (Hokkaido University, Japan)	
<ul style="list-style-type: none"> ● Jonathan Gómora Alarcón (National Autonomous University of Mexico, Mexico) The Suchiate River as a Mobile Boundary. Mexico Facing the Loss of National Territory ● Buddhi Shrestha (Bhumichitra Mapping, Nepal) Natural Environment and Shifting Borders of Nepal ● Paul Richardson (Far Eastern Federal University, Russia) Borderlands and Shifting Sovereignty Regimes in the South and East China Sea ● Reece Jones (University of Hawai'i, US) Border Walls: Security and the War on Terror in the US, India, and Israel 	

Session 2.14 Cross-border III	14:15-15:45 / Room 3 (503)
Moderator & Commentator: Mikhail Alexseev (San Diego State University, US)	
<ul style="list-style-type: none"> ● Eiki Berg (University of Tartu, Estonia) Will the Improved Cross-Strait Relations Lead to the Legitimation of 'One China Policy'? ● Heikki Eskelinen (University of Eastern Finland, Finland) Cross-border Interaction as a Place-based Development Strategy: The Case of the EU-Russia Borderland ● Mushtaq Kaw (University of Kashmir, India) Border Communities of Kargil & Iskardu in India & Pakistan: Issues & Alternatives ● Natalia Ryzhova & Olga Vasilieva (Economic Research Institute FEB RAS, Russia) Does National Border Matter For Russian-Chinese Trade? 	

Session 2.15 Cross-border IV	14:15-15:45 / Room 4 (404)
Moderator & Commentator: David Newman (Ben Gurion University, Israel)	
<ul style="list-style-type: none"> ● Magdalena Belof (Wrocław University of Technology, Poland) Baltic – Adriatic Corridor – from Spatial Vision to Political Competition ● Dhananjay Tripathi (South Asian University, India) Wagah Border Region: Bridging Indo-Pak Partition ● Akihiko Takagi (Kyushu University, Japan) Recent Changes in the Border Areas in the Western Part of Japan: Comparing Tsushima Island and Ishigaki Island ● David Newman (Ben Gurion University, Israel) Creating New Borders in Israel/Palestine 	

Session 2.16 Cross-border V	14:15-15:45 / Room 5 (405)
Moderator & Commentator: Adam Eberhardt (Centre for Eastern Studies, Poland)	
<ul style="list-style-type: none"> ● Alfred Colpaert (University of Eastern Finland, Finland) Eco-borders Visible from Space, the Effects of National Borders on the Landscape 	

- Maria Lähteenmäki (University of Eastern Finland, Finland)
Political Tourism in the Borderland between Finland and The Soviet Union in the 1920s and 1930s
- Chung-Tong Wu (University of Western Sydney, Australia)
Sino-Russian Border Regions—Missing the Growth Train?
- Jongseok Park (Hokkaido University, Japan)
North Korea's Border and Its Special Economic Zones: Focusing on its SEZ Strategy and Location Relevance

DAY 4 (Fri, 16 November)

Session 3.1 Local Initiatives I	9:30-11:00 / Room 2
<p>Moderator & Commentator: Anne-Laure Amilhat Szary (Université Joseph Fourier, France)</p> <ul style="list-style-type: none"> ● Natalia Ryzhova (Economic Research Institute, FEB RAS, Russia) Using and Leasing Farm Land in the Russian Border Regions: Policies, Discourses and Practices ● Shunsuke Nagashima (Kagoshima University, Japan) Shifts of Multiple Roles of Border Islands in the Kyusyu Chain Islands ● Aileen A. Espiritu (University of Tromsø, Norway) Identity Politics and the Politics of Identity: The Norwegian-Russian Border ● Emmanuel Brunet-Jailly & Helga Kristin Hallgrimsdottir (University of Victoria, Canada) Post 9/11 Local and Regional Group Dialogues and Initiatives across the 42d Parallel –Is the Canada/US Border Hardening and Limiting Interdependent Regional Initiatives? 	
Session 3.2 Imperial Borders	9:30-11:00 / Room 4
<p>Moderator & Commentator: Paul Richardson (Far Eastern Federal University, Russia)</p> <ul style="list-style-type: none"> ● Jonathan Bull (Hokkaido University, Japan) Turning Karafuto into Sakhalin, 1945-1949: A Case Study of a Border Region in Transition ● Mirzokhid Rakhimov (Institute of History AS Uzbekistan, Uzbekistan) Boundary Issues in Central Asia: Challenges and Perspectives ● Hiroshi Itani (Hokkaido University, Japan) Happy Days after the 'Happy End'? : The Modern History of the Kuril Islands (1875-1945) ● Sergey Vradiy (Institute of History, Archeology and Ethnology of the Far-Eastern People, FEB RAS, Russia) Russia-Korea-China Borderland and Korean Migrations: A Case Study of the XIX Century "Map of Russia" 俄國輿地圖 	
Session 3.3 Perception I	9:30-11:00 / Room 5
<p>Moderator: Andrew Burrige (Durham University, UK) Commentator: Heikki Eskelinen (University of Eastern Finland, Finland)</p> <ul style="list-style-type: none"> ● Edward Boyle (Hokkaido University, Japan) Bordering Sovereignty and Territory: Tracing the State Effect in Northern Japan ● Yuko Ishino (Tsuda College, Japan) Between an Imagined Border and a Reality: Ideas of the Finnish Eastern Border in the Context of Finnish-Russian Relations ● Naomi Chi (Hokkaido University, Japan) Imagined Community Revisited: Politics of Inclusion and Exclusion and the Case Study Migrant Workers, Marriage Migrants, and Ethnic Korean Gyopos in South Korea 	
Session 3.4 Local Initiatives II	11:15-12:45 / Room 2
<p>Moderator & Commentator: Martin van der Velde (Radboud University Nijmegen, Netherlands)</p> <ul style="list-style-type: none"> ● Kimberly Collins (California State University San Bernardino, US) A Study of Public Institutions, Goods, and Space at the U.S.-Mexican Border ● Sergey Sevastyanov (Far Eastern Federal University, Russia) 	

<p>Vladivostok and engaging with the Asia-Pacific</p> <ul style="list-style-type: none"> ● Margit Säre (Peipsi Center for Transboundary Cooperation, Estonia) Non-state Actors and Local Interest Groups in the Estonian-Russian Border Region, Transboundary Lake Peipsi Area ● Florine Meunier & Fabienne Leloup (Catholic University of Louvain, Belgium) The Cultural Policy at the Franco-Belgian Border. How Local Initiatives and Europe are Mutually Inter-connected?

Session 3.5 Theory & Practice I	11:15-12:45 / Room 3
<p>Moderator: Takashi Yamazaki (Osaka City University, Japan)</p> <p>Commentator: Mushtaq Kaw (University of Kashmir, India)</p> <ul style="list-style-type: none"> ● Sergey Lomov (Permanent Committee for Council of Ministers of the Union State, Russia) 'Desirable' Globalization: Overcoming the 'Curse' of Borders ● Frédéric Giraut (Université de Genève, Switzerland) How to Measure the Borderland Thickness in Europe? ● Moriel Ram (Ben-Gurion University, Israel) Creating a Peaceful Place of War: Revisiting the Border of the Golan Heights 	

Session 3.6 The Impact on International Relations	11:15-12:45 / Room 4
<p>Moderator & Commentator: Serghei Golunov (University of Tartu, Estonia)</p> <ul style="list-style-type: none"> ● Mikhail Alexseev (San Diego State University, US) First Image Inversed: WTO and the Politics of Russia-Georgia Border Crossings ● Minori Takahashi (Japan Society for the Promotion of Science, Japan) Denmark and the Dispute over Exploitation Rights in the Arctic ● Ilkka Liikanen (University of Eastern Finland, Finland) CBC in a Wider Europe and the Shaping of EU Common Policies of Foreign Affairs ● Adam Eberhardt (Centre for Eastern Studies, Poland) The Eastern Frontier of the European Union –Challenges and Opportunities 	

Session 3.7 KOREAN SPECIAL I (Society and Diasporas)	11:15-12:45 / Room 5
<p>Moderator & Commentator: Naomi Chi (Hokkaido University, Japan)</p> <ul style="list-style-type: none"> ● Kyung Won Yun (East Asian Society and Culture Forum, Korea) Post-Colonialism and Borders ● Iuliia Din (Korea University, Korea) Ethnic Identity of Sakhalin Korean Diaspora ● Hye In Han (Konkuk University, Korea) Nullified Borderline, Movable Hometown: Permission to Have the Restrictive Dual Nationality for Koreans Returning from Sakhalin and Their Changeable Identity ● Jeong Eun Lee (Sung Kong Hoe University, Korea) Changing Mobility, Unchanging Border: Differentiation of Social Status and Perception of the Korean-Chinese Society in South Korea 	

Session 3.8 Perception II	13:45-15:15 / Room 2
<p>Moderator: Sergey Sevastyanov (Far Eastern Federal University, Russia)</p> <p>Commentator: Jussi Laine (University of Eastern Finland, Finland)</p> <ul style="list-style-type: none"> ● Takako Sato (Hokkaido University, Japan) 	

<p>Religious Identity in Transition? A Case Study of the Emergence of a Mega Multinational Pentecostal Church in Japan</p> <ul style="list-style-type: none"> ● Daniel Meier (Oxford University, UK) <p>Identity Mobilizations in Middle Eastern Borderlands. A Comparison between South Lebanon, South Sudan and North of Iraq</p> <ul style="list-style-type: none"> ● Julien Thorez (Centre National de la Recherche Scientifique (CNRS), France) <p>Borders and Networks: The Making of National Space in Post-soviet Central Asia</p>
--

Session 3.9 Theory & Practice II	13:45-15:15 / Room 3
<p>Moderator & Commentator: Emmanuel Brunet-Jailly (University of Victoria, Canada)</p> <p>Commentator: David Newman (Ben-Gurion University, Israel)</p> <ul style="list-style-type: none"> ● Serghei Golunov (University of Tartu, Estonia) <p>Conceptualizing Border Crossing Issues: Pragmatic-Dialogical Approach</p> <ul style="list-style-type: none"> ● Laetitia Rouvière (Political Science Institut d'Etudes Politiques de Grenoble, France) <p>Governing cross-border and indigenous territorialities. The case of the Strategic Alliance Aymaras without Borders (Chile-Peru-Bolivia)</p> <ul style="list-style-type: none"> ● Tony Payan (University of Texas at El Paso, US) <p>Two-Level Theories, Fuzzy Sets and Border Construction</p>	

Session 3.10 East meets West	13:45-15:15 / Room 4
<p>Moderator & Commentator: Ilkka Liikanen (University of Eastern Finland, Finland)</p> <ul style="list-style-type: none"> ● Hiroshi Fukuda (Kyoto University, Japan) <p>Central Europe for Small Nations: Milan Hodža and his Strategy between Germany and Russia</p> <ul style="list-style-type: none"> ● Anton A. Kireev (Far Eastern Federal University, Russia) <p>Asian and European Borders of Russia: Typological Features</p> <ul style="list-style-type: none"> ● Vladimir Petrovskiy (Russian National Peace Council, Russia) <p>Helsinki Process' for Northeast Asia and Asia Pacific?</p> <ul style="list-style-type: none"> ● Kimie Hara (University of Waterloo, Canada) <p>Arctic 'Thaw' and the Cold War Frontiers in East Asia in the 21st Century</p>	

Session 3.11 KOREAN SPECIAL II (Northeast Asia: Past & Future)	13:45-15:15 / Room 5
<p>Moderator & Commentator: James W. Scott (University of Eastern Finland, Finland)</p> <ul style="list-style-type: none"> ● Kyung Hee Cho (Sung Kong Hoe University, Korea) <p>Imagined Mobility and the Reconstruction of the Borders: Experience of South Korea by Chongryon Zainichi Koreans</p> <ul style="list-style-type: none"> ● Stephen A. Royle (Queen's University Belfast, Northern Ireland, UK) <p>Contested Maritime Boundaries in the 1880s: the Case of Port Hamilton (Geomun-do)</p> <ul style="list-style-type: none"> ● Eric K. Hong (Hong Myeonki) (Northeast Asian History Foundation, Korea) <p>Three Border Regions that Surround the Korean Peninsula and Its Implications for Peace in Northeast Asia: Emphasis on the Border Region between North Korea and China</p> <ul style="list-style-type: none"> ● Bernhard Köppen (Institut für Naturwissenschaften und Naturwissenschaftliche Bildung, Germany) <p>Cross-Border-Cooperation at the Korean Demilitarized Zone? An Experimental Assessment of the North Korean Special Economic Zones Geumgagsan and Gaeseong</p>	

Special Lecture “Perspectives on Borders on the Korean Peninsula”	15:30-16:00 / Room 1
Speaker: <ul style="list-style-type: none">● Keun-Gwan Lee (Professor, College of Law, Seoul National University)	

Closing Plenary “Where are we headed for?”	16:20-18:40 / Room 1
Moderators & Speakers: <ul style="list-style-type: none">● Emmanuel Brunet-Jailly (University of Victoria, Canada)● Ilkka Liikanen (University of Eastern Finland, Finland)● David Newman (Ben-Gurion University, Israel)● Henk van Houtum (Radboud University Nijmegen, Netherlands)	

11. General Information

(1) Registration

The Conference Registration Desks for the Fukuoka session are located in **the 5th-floor lobby** of the **Fukuoka International Congress Center**. You can pick up the conference bag and name badge at the Conference Registration Desk. For registration or any administrative issues please enquire at the Conference Registration Desks. Please check the message board by the Registration Desks regularly for news and announcements.

(2) Badge

Your name badge, issued to you when you register, must be worn to all conference sessions and social events for identification and security purpose. The holder of the badge includes tickets of lunch, banquet in Fukuoka and cultural programs if you reserved during the prior online registration.

(3) Presentation & Language

Plan to arrive in the room at least 15-20 minutes before the beginning of the session. Oral presentation slots will be strictly limited to 15 minutes. There will be a Q&A session at the end of each session so please hold on to any questions you may have until then. At the discretion of the moderator, presentation time and Q&A time may be changed.

Presentation material must be made in English, using Microsoft PowerPoint 2007/2010 or Adobe PDF if you are using our PCs pre-installed at the conference site. You may use your personal laptop as long as it has a VGA 15 pins socket video connector compatible with the projector format resolution.

The official language of BRIT XII-2012 is English. For certain presentations such as the two “Japan Special Sessions”, simultaneous interpretation of Japanese and English will be provided.

(4) Internet Access

Free Wireless Internet access will be provided on the 5th floor of the Fukuoka International Congress Center.

(5) Electricity in Japan and Korea

The voltage used throughout Japan is uniformly 100V. There are two kinds of frequencies in use; 50 Hertz in eastern Japan and 60 Hertz in western Japan including Fukuoka. There are no columnar-shaped plugs or 3-pin plugs used in Japan but 2-flat-pin plugs are used instead. The plug type is A or B. It is therefore advised to purchase a plug adapter beforehand.

The standard voltage in Korea is 220V. The outlet has two round holes and is the same type used in France, Germany, Austria, Greece, Turkey, and many other countries. The typical plug type is C or E/F. However, in Toyoko-inn Busan Station 2, there is also the same type of outlet as in Japan. Therefore, guests can use the plug type A or B in Toyoko-inn Busan Station 2.

(6) Foreign Currency Exchange

There are couple of foreign currency exchange kiosks in Fukuoka and Busan. You may exchange your money at the airport and the port of Busan. There are also many ATMs near the hotels and the conference venues both in Fukuoka and Busan.

(7) Climate

During November in Fukuoka, daily highs decrease from roughly 15°C to 10°C over the course of the month. However, occasionally, daily highs can exceed 20°C or drop below 5°C. Daily lows generally range from 6°C to 12°C, but have been known to drop to 3°C or even exceed 16°C. The temperature difference between day and night is large and therefore a warm jacket or coat may be necessary.

In Tsushima and Busan, it will be a little colder than in Fukuoka. It is better to bring a coat, because the night temperature in the evenings may be low.

(8) Insurance & Illness

Registration fees do not include personal, travel or medical insurance of any kind. Delegates are advised when registering for the conference and booking travel that a travel insurance policy should be taken out to cover risks including (but not limited to) loss, cancellation, medical costs and injury. BRIT-XII 2012 and/or the conference organizers will not accept any responsibility for any delegate failing to insure.

In case you become sick or are injured during the conference, please come to the Registration Desks or ask our staff for help if you feel you need it.

12. Scientific Committee

Dr. AMILHAT-SZARY, Anne-Laure	Université Joseph Fourier, Grenoble	France
Prof. BRUNET-JAILLY, Emmanuel	University of Victoria, British Columbia	Canada
Dr. EBERHARDT, Adam	Center for Eastern Studies, Warsaw	Poland
Prof. GIRAUT, Frédéric	Université de Genève	Switzerland
Dr. GOLUNOV, Serghei	Volgograd State University	Russia
Prof. GOSAR, Anton	University of Primorska, Koper	Slovenia
Prof. GUO, Rongxing	Peking University	China
Prof. KAW, Mustaq	University of Kashmir	India
Prof. LIIKANEN, Ilkka	Karelian Institute, U. of Eastern Finland	Finland
Dr. LIMAYE, Satu	East West Center in Washington	US
Dr. MIRANDA, Sergio González	Universidad Arturo Prat	Chile
Prof. NEWMAN, David	Ben Gurion University	Israel
Prof. PRATT, Martin	IBRU, Durham University	UK
Prof. SEVASTYANOV, Sergey	Far Eastern Federal University	Russia
Prof. SHEN, Haimei	Yunnan University of Nationalities	China
Dr. TANGSEEFA, Decha	Thammasat University, Bangkok	Thailand
Prof. VAN DER VELDE, Martin	Radboud University, Nijmegen	Netherlands

13. Journal of Eurasia Border Review (EBR)



The *Eurasia Border Review* (hereafter referred to as “EBR”) is a peer-reviewed, semi-annually published periodical of the Global Center of Excellence Program “Reshaping Japan’s Border Studies” at the Slavic Research Center, Hokkaido University. The *EBR* is committed to publishing in-depth scholarly research for a diverse audience of scholars, practitioners and policy decision-makers and welcomes original manuscript submissions from all social sciences and humanities disciplines that focus on border or borderland issues in the wider Eurasian region. In order to assure the publication of original work, authors are kindly asked not to submit manuscripts that are currently under review by other journals.

<http://borderstudies.jp/en/publications/review/>

Table of Contents of the Latest Issue (vol.3, no.2, 2012 Fall)

<ARTICLES>

Border Demarcation, Cross-Border Migration, and Interethnic Hostility in the Russian Far East

Mikhail Alexseev

Dark Side of the Rock: Borders, Exceptionalism, and the Precarious Case of Ceuta and Melilla

Can E. Mutlu and Christopher C. Leite

Managing Borders and Migrants through Citizenship: A Japanese Case

Hideki Tarumoto

Borders, Boundaries and Frontiers: Notes on Jerusalem’s Present Geopolitics

Haim Yacobi

China’s “Frontiers”: Issues Concerning Territorial Claims at Sea — Security Implications in the East China Sea and the South China Sea (Part II)

Koichi Sato

<RESEARCH NOTES>

Energy Security: The Functional Area of Regional Cooperation for South Asia

Dhananjay Tripathi

Primorskii Borderland on the “Map of Russia” Aguk-yeojido

Sergey Yu. Vradiy

<PERSPECTIVE>

Exploring Solutions to the U.S. Military-Base Issues in Okinawa

Tomohiro Yara

<BOOK REVIEW>

Alison Mountz, *Seeking Asylum: Human Smuggling and Bureaucracy at the Border*, University of Minnesota Press: Minneapolis, MN: 2010

Andrew BurrIDGE

Stuart Elden, *Terror and Territory: The Spatial Extent of Sovereignty*, University of Minnesota Press: Minneapolis, MN: 2009

Edward Boyle



Global COE Program "Reshaping Japan's Border Studies"
Slavic Research Center at Hokkaido University

EURASIA BORDER REVIEW

Volume 3 • Special Issue • Summer 2012

China's Post-Revolutionary Borders, 1940s-1960s

Edited by David Wolff and Akihiro Iwashita

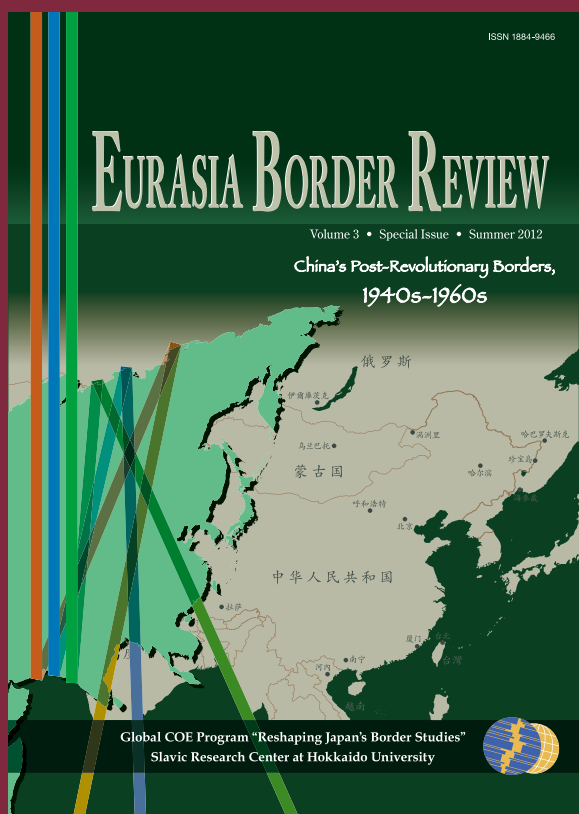

CONTENTS

Foreword

Akihiro Iwashita

Introduction

David Wolff

<NORTH>

Carving up the Steppes: Borders, Territory and Nationalism in Mongolia, 1943-1949

Sergey Radchenko

A Very Orderly Friendship: The Sino-Soviet Border under the Alliance Regime, 1950-1960

Sören Urbansky

<SOUTH>

Chinese Borders and Indigenous Parallels: France, Vietnam, and the 'Korean Model'

Pierre Grossier

The First Taiwan Strait Crisis and China's 'Border' Dispute Around Taiwan

Haruka Matsumoto

<WEST>

Sino-Indian Relations, 1954-1962

Lorenz Lüthi

Quietly Encouraging Quasi-Alignment: US-Indian Relations, the Sino-Indian Border War of 1962, and the Downfall of Krishna Menon

James G. Hershberg

<RESEARCH NOTE>

New Documents on the Sino-Soviet Ussuri Border Clashes of 1969

Dmitri S. Ryabushkin

Organized by:
Hokkaido University, Japan
Dongseo University, Korea
Kyushu University, Japan

Cosponsored by :
Japan Society of Island Studies (JSIS)
Japan International Border Studies Network (JIBSN)
Kyushu Economic Research Center
Scientific Research Program on Innovative Area
“Comparative Research on Major Regional Powers in Eurasia”
Slavic Research Center, Hokkaido University

With the cooperation of:
Fukuoka City Government
Fukuoka Convention & Visitors Bureau (FCVB)
Busan City Government
Busan Convention & Visitors Bureau (Busan CVB)

With the international support from :
Association for Borderlands Studies (ABS)

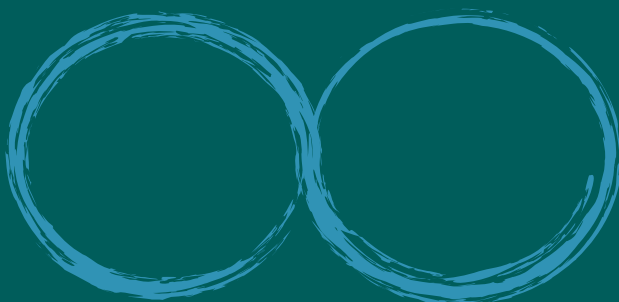

主催／주최
北海道大学
동서대학교
九州大学

共催／공동
日本島嶼学会
境界地域研究ネットワークJapan
九州経済調査協会
新学術領域研究「ユーラシア地域大国の比較研究」
(北海道大学スラブ研究センター)

後援／후원
福岡市
福岡観光コンベンションビューロー
부산광역시
부산관광컨벤션뷰로

<http://www.borderstudies.jp/brit2012/top.html>